

MODEL: MNZ6

MONSTER®

Z6

**ALL-IN-ONE
PA SPEAKER**



User Manual

INDEX

Warnings	2-3
User's General Instructions	4-8
Specifications	9
Warranty	10

WARNING

To reduce the risk of fire or electric shock, do not expose this apparatus to rain or moisture.

CAUTION

Use of controls or adjustments or performance of procedures other than those specified may result in hazardous radiation exposure.

CAUTION: These servicing instructions are for use by qualified service personnel only. To reduce the risk of electric shock do not perform any servicing other than that contained in the operating instructions unless you are qualified to do so.

FCC Warning Statement

Changes or modifications not expressly approved by the party responsible for compliance could void the user's authority to operate the equipment.

This equipment has been tested and found to comply with the limits for a Class B digital device, pursuant to Part 15 of the FCC Rules.

These limits are designed to provide reasonable protection against harmful interference in a residential installation. This equipment generates, uses, and can radiate radio frequency energy and, if not installed and used in accordance with the instructions, may cause harmful interference to radio communications.

However, there is no guarantee that interference will not occur in a particular installation. If this equipment does cause harmful interference to radio or television reception, which can be determined by turning the equipment off and on, the user is encouraged to try to correct the interference by one or more of the following measures:

- Reorient or relocate the receiving antenna.
- Increase the separation between the equipment and receiver.
- Connect the equipment into an outlet on a circuit different from that to which the receiver is connected.
- Consult the dealer or an experienced radio/TV technician for help.

FCC Radiation Exposure Statement:

This equipment complies with FCC radiation exposure limits set forth for an uncontrolled environment. In order to avoid the possibility of exceeding the FCC radio frequency exposure limits, Human proximity to the antenna shall not be less than 20cm (8 inches) during normal operation.

UNPACKING

Check that you have all of the following items.

If any item is missing, please contact the customer service hotline for assistance.

The hotline number is printed on the cover page of this user manual.

- Monster Z6 PA Speaker
- AC Power Cable
- Wireless Microphone
- Telescoping Tripod Speaker Stand
- User Manual (with Warranty Statement)
- Quick Start Guide

IMPORTANT SAFETY INSTRUCTIONS

TO PREVENT FIRE OR SHOCK HAZARD, DO NOT USE THIS PLUG WITH AN EXTENSION CORD, RECEPTACLE OR OTHER OUTLET UNLESS THE BLADE CAN BE FULLY INSERTED TO PREVENT BLADE EXPOSURE. TO PREVENT FIRE OR SHOCK HAZARD, DO NOT EXPOSE THIS APPLIANCE TO RAIN OR MOIST.



The lightning flash with arrow-head symbol, within an equilateral triangle is intended to alert the user to the presence of uninsulated 'dangerous voltage' within the product's enclosure that may be of sufficient magnitude to constitute a risk of electric shock to persons.

CAUTION

RISK OF ELECTRIC SHOCK
DO NOT OPEN

WARNING: TO REDUCE THE RISK OF ELECTRIC SHOCK DO NOT REMOVE COVER (OR BACK), NO USER SERVICEABLE PARTS INSIDE REFER SERVICING TO QUALIFIED SERVICE PERSONNEL.



The exclamation point within an equilateral triangle is intended to alert the user to the presence of important operating and maintenance (servicing) instructions in the literature accompanying the appliance.

1. **READ INSTRUCTIONS** - All the safety and operating instructions should be read before the product is operated.
2. **RETAIN INSTRUCTIONS** - The safety and operating instructions should be retained for future reference.
3. **HEED WARNINGS** - All warnings on the product and in the operating instructions should be adhered to.
4. **FOLLOW INSTRUCTIONS** - All operating and use instructions should be followed.
5. **CLEANING** - Unplug this product from the wall outlet before cleaning. Do not use liquid cleaners or aerosol cleaners. Clean only with a dry cloth.
6. **ATTACHMENTS** - Do not use attachments not recommended by the product manufacturer as they may cause hazards.
7. **ACCESSORIES** - Do not place this product on an unstable cart, stand, tripod, bracket, or table. The product may fall, causing serious injury to a child or adult, and serious damage to the product. Use only with a cart, stand, tripod, bracket, or table recommended by the manufacturer, or sold with the product. Any mounting of the product should follow the manufacturer instructions, and should use a mounting accessory recommended by the manufacturer. A product and cart combination should be moved care-quick stops, excessive force and uneven surfaces may cause the product and cart combination to overturn.
8. **VENTILATION** - Slots and openings in the cabinet are provided for ventilation and to ensure reliable operation of the product and to protect it from overheating, and these openings must not be blocked or covered. The openings should never be blocked by placing the product on a bed, sofa, rug or other similar surface. This product should not be placed in a built-in installation, such as a bookcase or rack, unless proper ventilation is provided or the manufacturer's instructions have been adhered to.
9. **POWER SOURCES** - This product should be operated only from the type of power source indicated on the marking label. If you are not sure of the type of power supply to your home, consult your product dealer or local power company. For products intended to operate from battery power, or other sources, refer to the operating instructions.
10. **GROUNDING OR POLARIZATION** - This product may be equipped with a polarized alternating-current line plug (a plug having one blade wider than the other). This plug will fit into the power outlet only one way. This is a safety feature: If you are unable to insert the plug fully into the outlet, try reversing the plug. If the plug should still fail to fit, contact your electrician to replace your obsolete outlet. Do not defeat the safety purpose of the polarized plug.
11. **POWER-CORD PROTECTION** - Power-supply cords should be routed so that they are not likely to be walked on or pinched by items placed upon or against them, paying particular attention to cords at plugs, convenience receptacles, and the point of exit from the product.
12. **NON-USE PERIODS** - The power cord of the product should be unplugged from the outlet when left unused for long periods of time.
13. Do not use this apparatus near water.
14. Do not install near any heat sources such as radiators, heat registers, stoves or other apparatus (including amplifiers) that produce heat.
15. Refer all servicing to qualified service personnel. Servicing is required when the apparatus has been damaged in any way, such as power - supply cord or plug is damaged, liquid has been spilled or objects have fallen into the apparatus, the apparatus has been exposed to rain or moisture, does not operate normally, or has been dropped.
16. Mains plug is used as disconnect device and it should remain readily operable during intended use. In order to disconnect the apparatus from the mains completely, the mains plug should be disconnected from the mains socket outlet completely.



CONTROLS PANEL

1. LED Display with Clock
2. BT (Bluetooth® Source) Button
3. Source Button
4. Previous (back arrow) Button
5. Next (forward arrow) Button
6. Play/Pause Button
7. Number (Preset) Buttons
8. Master Volume Knob
9. Microphone Gain Knob
10. Microphone Echo Knob
11. Microphone 1 1/4" Input and XLR Input
12. Microphone 2 1/4" Input and XLR Input
13. Auracast/Legacy Switch
14. AC Input
15. Clock/Microphone pairing button
16. Power (Green) LED Indicator Light
17. Bluetooth® (Blue) LED Indicator Light
18. Wireless Mic Indicator Light
19. Lighting Button
20. Auracast & TWS (Connection) Button
21. Bass (Boost) Button
22. Bass/Mid/Treble Button
23. XLR-Out
24. XLR-In
25. AUX-in (3.5mm)
26. On/Off Switch

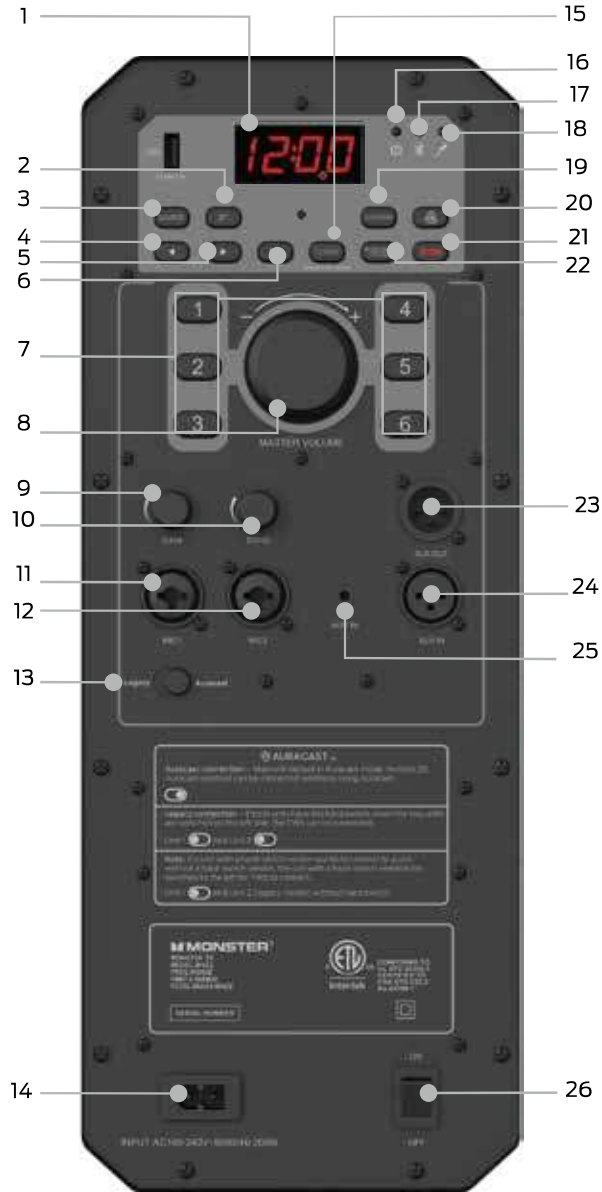

LED Display

27. Clock
28. AUX- In Source Icon
29. Bluetooth® Source Icon
30. FM Radio Icon



Power ON/OFF Switch:

- Toggle switch to ON position:
 1. Green power LED Indicator light and LED Display will power on.
 2. The unit voice prompt will say, "Power on."
 3. Automatically enters into Bluetooth® pairing status
- Toggle switch to OFF position and all LED Indicators and the LED Display will turn off.

BT (Bluetooth®) Button:

- Switch to Bluetooth® Audio Source:
 1. While in another audio source, press the BT Button to switch to Bluetooth® mode or cycle through audio sources using the source button.
 2. The unit will automatically disconnect from the current device.
- Bluetooth® pair audio device:
 1. Set unit source to Bluetooth®.
 2. Long press BT Button for 2 seconds to enter into pairing status.
 3. Select "MONSTER Z6" from your Bluetooth® enabled audio device.
 4. The unit voice prompt will say, "Connected," when successfully paired.
 5. The blue Bluetooth® indicator light will remain on.
 6. If the signal moves out of range the blue Bluetooth® indicator light will blink and disconnect if the connection is not reestablished after 5 minutes.

Auracast/Legacy switch to the right, the unit bluetooth name : MONSTER Z6 Auracast/Legacy switch to the left, the unit bluetooth name : MONSTER Z6 TWS

- Disconnect Bluetooth® audio device connection:
 1. Set unit source to Bluetooth®.
 2. Long press BT Button for 2 seconds to enter into pairing status.
 3. The unit voice prompt will say, "Disconnected".
 4. The blue Bluetooth® LED Indicator light will begin to flash.
 5. Unit will enter pairing status.

Play/Pause Button:

- Play/Pause Button works with Bluetooth®
 - While audio is playing, press the Play Button to pause playback.
 - While audio is paused, press the Play Button to resume playback.

Master Volume Knob:

- Increase overall volume in playback mode :
 - Default volume level is 10.
 - Rotate master volume knob clockwise. The power LED Indicator blinks when the max level of 32 is reached.
- Decrease overall volume in playback mode:
 - Rotate master volume knob counter-clockwise. The power LED Indicator blinks when the minimum volume level of 0 (mute) is reached.

Microphone Control:

- XLR and ¼" Ports (Mic 1 and Mic 2):
 - Include XLR and ¼" microphones/instrument inputs
- Gain Knob (Mic 1 and Mic 2):
 - Rotate the gain knob clockwise to increase or counter-clockwise to decrease the level on each channel.
- Echo Effect Knob (Mic 1 and Mic 2):
 - Rotate the echo knob clockwise to increase or counter-clockwise to decrease the level on each channel.

Previous and Next (arrow) Buttons:

- FM radio source controls:
 - LED display FM indicator icon will light up in FM mode.
 - Short press the previous or next button to adjust the FM radio frequency shown on LED display.
 - Long press the previous or next button to search for radio stations.
- Bluetooth® source controls:
 - LED display BT indicator icon will light up in Bluetooth® mode.
 - The previous/next buttons will change the audio track

SOURCE Button:

- Short press the SOURCE button to cycle through the different audio sources:
BT (Bluetooth®) --> AUX --> FM (radio)

BASS Button:

- Press the button to turn on/off the BASS (boost). The LED will display "b on" or "b off."

XLR Out:

- While in audio sources: AUX-in, BT (Bluetooth®), FM radio, or connect the unit to another active (powered) speaker via the XLR line out.

TWS Button (True Wireless System Dual Pairing):

TWS Pairing

(Make sure both unit A and B are in close proximity to each other)

- Long press the **Auracast & TWS** button to enter into pairing status. The **Bluetooth®** indicator LED will alternate flashing blue and red.
- Press and hold the **Auracast & TWS** button of unit **A** to enter **TWS** searching mode while unit **B** is set to Bluetooth® pairing mode.
- The unit **A** (TX) Bluetooth® indicator LED will light up purple when connected, while the indicator LED for unit **B** (RX) will be solid red.
- The unit voice prompt will say, "Synchronized."



Auracast & TWS
(Connection) Button

Disconnect TWS:

1. Long press the **Auracast & TWS** button.

Using Auracast™ on Your Speaker /

Auracast™ is a Bluetooth audio broadcasting technology that allows one device to share its audio with multiple receivers. Whether you're syncing multiple speakers for an immersive sound experience or broadcasting to headphones, Auracast makes it seamless.

How to Connect AURACAST™

A. How to find the TX and RX

TX Mode Setup:

Connect your smart device to a **Bluetooth** unit
Press the **Auracast** button on the unit to activate **Transmitter (TX) mode**.

RX Mode Setup:

- Power on a second **Bluetooth** unit without pairing it to any smart device.
- Press the **Auracast** button on the unit to activate **Receiver (RX) mode** and **scan** for available broadcasts.

TX / RX Range

The receiving distance range between TX and RX is 10 meters, and the distance between the Bluetooth phone and TX speaker is 5 meters. To optimize Auracast mode, extend tripod to improve signal, enhance sound quality & stability.

B. The Auracast indicator

When the **TX LED solid purple** and the RX LED flashes red, the unit is in the search mode.
When the **TX LED is solid purple** and the **RX LED is solid red**, the unit is in Connect Mode.

C. Setting auracast in you smart phone (Please make sure your phone has auracast function)

When using the smart device Auracast, Access Auracast through your device's settings (e.g., **Settings > Connections > Bluetooth > Broadcast sound using Auracast**). Here, you can Name

Your Broadcast: Customize a unique identifier for your audio stream

Set Privacy: Setting the password "None" or "8888" for our product.

And then our products will be in RX mode and can receive smart device programs.

Auracast/Legacy switch

The **Auracast** function is default on the main (Auracast & Legacy switch on right side)

When the **TWS switch** is turned on (Auracast & Legacy switch on left side), Auracast is turned off.

Long press "**TWS**" button for 2 seconds to enter to the pairing mode. Long press TWS button to disconnected the **TWS**.

Z6 can be teamed with Monster speakers **X6**, **Gi30** and **Rockin' Roller X** for TWS.

Note: It is necessary to search for a new Bluetooth name and reconnect it.

1-6 Number Button:

1. **Equalizer** presets available in BT (Bluetooth®) and AUX audio sources.
2. Short press a number (1-6) button to set the preset. The LED display will show the selected equalizer setting: "Eq-1, Eq-2, . . . Eq-6."
3. Save and select FM Radio station presets.
4. Short press a number (1-6) button to set the preset station. The LED display will show the selected preset: "P1, P2, . . . P6."
5. Long press a number (1-6) button to save an FM radio station as a preset. The LED display will show the saved preset: "P1, P2, . . . P6."

BASS/MID/TREBLE Buttons:

A. Bass adjustment in working mode:

1. Press the BASS/MID/TREBLE button once to enter bass level status.
2. The LED display will show the default setting of "b 00."
3. Turn the VOLUME knob clockwise to increase or counter-clockwise to decrease levels between -06 to 06.

B. MID adjustment in working mode:

1. Press the BASS/MID/TREBLE button twice to enter MID level status.
2. The LED display will show the default setting of "C 00."
3. Turn the VOLUME knob clockwise to increase or counter-clockwise to decrease levels between -06 to 06.

C. Treble adjustment in working mode:

1. Short press the BASS/MID/TREBLE button triple to enter treble level status.
2. The LED display will show the default setting of "t 00."
3. Turn the VOLUME knob clockwise to increase or counter-clockwise to decrease levels between -06 to 06.

CLOCK/Microphone pairing button (Speaker):

1. Turn on the unit, press the **CLOCK/Microphone pairing button**, the display will show "12:00"
2. After connecting the smartphone, the popup window on the phone needs to have access to synchronize with the time on the smartphone.
3. The time will be refreshed each time you press the **CLOCK/Microphone pairing button**, and the display will show the current time for 10 seconds, and it will be back to show "**BT**"
4. If the smart phone is disconnected from the unit, the time won't show on the display.
5. Press the **CLOCK/Microphone pairing button**, the display will show "12:00 "
6. When the unit is on **AUX** or **FM** mode, Press the **CLOCK/Microphone pairing button**, the display will show "12:00 "
7. **To pair the Wireless Microphone**, long press the **CLOCK/Microphone pairing button**, for 5 secs.
Long press for 5 seconds to **connect** or **disconnect** wireless microphone

Wireless Microphone Pairing (Mic):

1. Long press the **POWER** button on wireless microphone for 2 seconds.
2. Double Click **Wireless Microphone** button, enter pairing mode, the **White** LED is flashing.
3. Long press on speaker **CLOCK/Microphone pairing button**, for 5 seconds to pair wireless microphone, the white LED is flashing.
4. After a successful connection, both the **White** LED on the main unit and on the speaker will become a white solid.
5. The wireless microphone and speaker has been successfully connected and can be used.



Unscrew battery cover to insert or remove AA batteries.

LIGHTING Button:

- Short press the LIGHTING button to cycle through the 15 available light modes. The LED display will indicate mode number: "L01, L02, L03 ... OFF."

Light modes included:

DANCE -> SPIN -> SWIRL -> DYNAMIC-> FOLLOW-> SPARK-> SUNSET-> MOOD-> PACE-> RED-> GREEN-> BLUE-> AMBER-> PURPLE-> TEAL-> OFF

NOTE: Only the following modes work with the FM Radio audio sources:

RED->GREEN-> BLUE->AMBER->PURPLE->TEAL-> OFF

DANCE LIGHT MODE: High frequencies will register on the top light bar, low frequencies on the four side light bars (two on the right and two on the left) and middle range on the light ring around the sub woofer.

- Long press the LIGHTING button to turn off the RGB LED lights.

Tripod Speaker Stand Assembly:

1. Fully extend the speaker stand tripod legs on a flat, stable surface and tighten the adjustment knob at the bottom of the stand, where the legs meet and fold.
2. Raise the mounting pole up to the appropriate height needed and tighten the side adjustment knob.
3. Insert the pin into the bottom pin-hole so the mounting pole stays at your set height.
4. Mount the PA speaker onto the stand by inserting the mounting pole into the bottom of unit, making sure to adjust the bottom knob so that the screw is not blocking the opening (turn counter-clockwise if needed), and tighten clockwise.

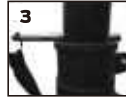

Technical Specs:

- 650 Watts Max of Audio Power
- Sub-woofer: 15" (inch)
- Bluetooth® 5.4
- Frequency Response: 40Hz–20KHz
- Product Dimensions (L x W x H) Inches:
20.69 x 12.13 x 27.55
- Product Dimensions (L x W x H) mm: 525.5 x 308 x 699.7
- Tweeter: 1" (inch)
- AC Power 100-240 Volt
- THD + Noise: <10%
- S/N Ratio: >65dB
- SPL :110dB±10%
- RGB LED Lights

Limited Warranty

Model: MNZ6

This Monster-branded product, marketed as new, in the original carton to the original purchaser ("Product"), is warranted by Russell Distribution Company, LLC against manufacturing defects in materials and workmanship for a limited warranty period of Ninety (90) Days for Labor and One (1) year for Parts. This Limited Warranty is conditioned upon proper use of Product by you, the Purchaser.

This Limited Warranty does not apply to store display products and product sold as a "marked down" special, in "as is" condition, "close outs", "liquidation and clearance sales", "open box", products missing accessories, or no fault found.

Proof of purchase in the form of a Bill of Sale, Receipt or Receipted Invoice is evidence the Product is within the limited warranty period. The Bill of Sale, Receipt or Receipted Invoice must be presented as a pre-condition to obtaining the limited warranty service.

This limited warranty begins on the original date of purchase and is valid only on Products purchased through authorized dealers and used in the United States, and Puerto Rico, by the original Purchaser. To receive warranty service, the Purchaser must first contact us for problem determination and service procedures. The original dated bill of sale, receipt or receipted invoice must be presented upon request as proof of purchase.

We will repair your product or if repairs cannot be made, we will replace it at no charge with the same or similar product. If the Product is defective as specified in this limited warranty during the limited warranty period, we may use new or remanufactured parts to repair the Product. All replaced parts and products become our property and must be returned to us. Replacement parts and products assume the remaining original limited warranty, or ninety (90) days, whichever is longer.

Product freight must be prepaid by you, the original Purchaser and shipped in either its original packaging or packaging affording an equal degree of protection. We will not be responsible for or obligated to replace damaged Products.

If the Product is received damaged, it is your responsibility as the consumer to file a claim against the carrier. We will only store the damaged Product for 30 days and reserve the right, in our sole discretion, to dispose of the damaged Product or ship it back to you at your expense after 30 days.

This limited warranty covers manufacturing defects in materials and workmanship encountered in normal, and except to the extent otherwise expressly provided for in this statement, noncommercial use of this Product, and shall not apply to the following, including, but not limited to: Damage which occurs in shipment; delivery and installation; applications and uses for which this Product was not intended; altered Product or serial numbers; cosmetic damage or exterior finish; accidents, abuse, neglect, fire, water, lightning or other acts of nature; use of products, equipment, systems, utilities, services, hardware, supplies, accessories, applications, installations, repairs, external wiring or connectors not supplied or authorized by us or the manufacturer, which damage this Product or result in service problems; incorrect electrical line voltage, fluctuations and surges; customer adjustments and failure to follow operating instructions, cleaning, maintenance and environmental instructions that are covered and prescribed in the instruction book; reception problems and distortion related to noise, echo, interference or other signal transmission and delivery problems; burned-in images. Uninterrupted or error-free operation of the Product is not warranted.

THERE ARE NO EXPRESS OR IMPLIED WARRANTIES OTHER THAN THOSE LISTED AND DESCRIBED ABOVE, AND NO WARRANTIES WHETHER EXPRESS OR IMPLIED, INCLUDING, BUT NOT LIMITED TO, ANY IMPLIED WARRANTIES OF MERCHANTABILITY OR FITNESS FOR A PARTICULAR PURPOSE, SHALL APPLY AFTER THE EXPRESS WARRANTY PERIODS STATED ABOVE, AND NO OTHER EXPRESS WARRANTY OR GUARANTY GIVEN BY ANY PERSON, FIRM OR CORPORATION WITH RESPECT TO THIS PRODUCT SHALL BE BINDING ON US. REPAIR OR REPLACEMENT AS PROVIDED UNDER THIS LIMITED WARRANTY IS YOUR EXCLUSIVE REMEDY AS THE CONSUMER. WE SHALL NOT BE LIABLE FOR ANY INCIDENTAL, OR CONSEQUENTIAL DAMAGES FOR BREACH OF ANY EXPRESS OR IMPLIED WARRANTY ON THIS PRODUCT; EXCEPT TO THE EXTENT PROHIBITED BY APPLICABLE LAW, ANY IMPLIED WARRANTY OF MERCHANTABILITY OR FITNESS FOR A PARTICULAR PURPOSE ON THIS PRODUCT IS LIMITED FOR THE DURATION OF THIS LIMITED WARRANTY. THIS LIMITED WARRANTY SHALL NOT EXTEND TO ANYONE OTHER THAN THE ORIGINAL PURCHASER OF THIS PRODUCT, IS NONTRANSFERABLE AND STATES YOUR EXCLUSIVE REMEDY.

Some states do not allow limitations on how long an implied warranty lasts, or the exclusion or limitation of incidental or consequential damages, so the above limitations or exclusions may not apply to you. This limited warranty gives you specific legal rights, and you may also have other rights which vary from state to state. Any provision contained herein which is found contrary to state or local laws shall be deemed null and void and the remaining provisions shall continue in full force and effect.

For Customer Service, please visit our website: mymonsteraudio.com



Distributed by Russell Distribution Company, LLC
7801 Hayvenhurst Avenue
Los Angeles, CA 91406

www.mymonsteraudio.com

Monster and the Monster logo are registered trademark of Monster, Inc., and its subsidiaries in the U.S., and other countries, used under license.

The Bluetooth® word mark and logos are registered trademark owned by Bluetooth SIG, Inc.
Other trademarks and trade names are those of their respective owners.

Model# MNZ6

Version: 1.1