



User Manual

BTW249

*Wireless Indoor/Outdoor Speakers
with EZ-Play Technology*



	FOR QUESTIONS OR TECHNICAL SUPPORT
	Please call: 1-800-976-0677
	Please do not return this product to the store.

TABLE OF CONTENTS

IMPORTANT SAFETY INSTRUCTIONS	3
UNPACKING	4
GETTING STARTED	5
BLUETOOTH CONNECTION (Bluetooth Devices)	5
E-Z PLAY CONNECTION	6
CONNECT TO MULTIPLE SETS OF BTW249 SPEAKERS	6
CONNECTION USING AUX INPUT	7
LED STATUS INDICATORS	7
AUDIO CONFIRMATION	7
WALL MOUNTING	7
TROUBLESHOOTING	8
SPECIFICATIONS	8
LIMITED WARRANTY	9

IMPORTANT SAFETY INSTRUCTIONS

TO PREVENT FIRE OR SHOCK HAZARD, DO NOT USE THIS PLUG WITH AN EXTENSION CORD, RECEPTACLE OR OTHER OUTLET UNLESS THE BLADE CAN BE FULLY INSERTED TO PREVENT BLADE EXPOSURE. TO PREVENT FIRE OR SHOCK HAZARD, DO NOT EXPOSE THIS APPLIANCE TO RAIN OR MOIST.



The lightning flash with arrow-head symbol, within an equilateral triangle is intended to alert the user to the presence of uninsulated 'dangerous voltage' within the product's enclosure that may be of sufficient magnitude to constitute a risk of electric shock to persons.

CAUTION

RISK OF ELECTRIC SHOCK
DO NOT OPEN

WARNING: TO REDUCE THE RISK OF ELECTRIC SHOCK DO NOT REMOVE COVER (OR BACK), NO USER SERVICEABLE PARTS INSIDE REFER SERVICING TO QUALIFIED SERVICE PERSONNEL.



The exclamation point within an equilateral triangle is intended to alert the user to the presence of important operating and maintenance (servicing) instructions in the literature accompanying the appliance.

1. **READ INSTRUCTIONS** - All the safety and operating instructions should be read before the product is operated.
2. **RETAIN INSTRUCTIONS** -The safety and operating instructions should be retained for future reference.
3. **HEED WARNINGS** - All warnings on the product and in the operating instructions should be adhered to.
4. **FOLLOW INSTRUCTIONS** - All operating and use instructions should be followed.
5. **CLEANING** - Unplug this product from the wall outlet before cleaning. Do not use liquid cleaners or aerosol cleaners. Clean only with a dry cloth.
6. **ATTACHMENTS** - Do not use attachments not recommended by the product manufacturer as they may cause hazards.
7. **ACCESSORIES** - Do not place this product on an unstable cart, stand, tripod, bracket, or table. The product may fall, causing serious injury to a child or adult, and serious damage to the product. Use only with a cart, stand, tripod, bracket, or table recommended by the manufacturer, or sold with the product. Any mounting of the product should follow the manufacturer instructions, and should use a mounting accessory recommended by the manufacturer. A product and cart combination should be moved care-quick stops, excessive force and uneven surfaces may cause the product and cart combination to overturn.
8. **VENTILATION**- Slots and openings in the cabinet are provided for ventilation and to ensure reliable operation of the product and to protect it from overheating, and these openings must not be blocked or covered. The openings should never be blocked by placing the product on a bed, sofa, rug or other similar surface. This product should not be placed in a built-in installation, such as a bookcase or rack, unless proper ventilation is provided or the manufacturer*instructions have been adhered to.
9. **POWER SOURCES** - This product should be operated only from the type of power source indicated on the marking label. If you are not sure of the type of power supply to your home, consult your product dealer or local power company. For products intended to operate from battery power, or other sources, refer to the operating instructions.
10. **GROUNDING OR POLARIZATION** - This product may be equipped with a polarized alternating-current line plug (a plug having one blade wider than the other). This plug will fit into the power outlet only one way. This is a safety feature: If you are unable to insert the plug fully into the outlet, try reversing the plug. If the plug should still fail to fit, contact your electrician to replace your obsolete outlet. Do not defeat the safety purpose of the polarized plug.
11. **POWER-CORD PROTECTION** - Power-supply cords should be routed so that they are not likely to be walked on or pinched by items placed upon or against them, paying particular attention to cords at plugs, convenience receptacles, and the point of exit from the product.
12. **NON-USE PERIODS** - The power cord of the product should be unplugged from the outlet when left unused for long periods of time.
13. Do not use this apparatus near water.
- 14 Do not install near any heat sources such as radiators, heat registers, stoves or other apparatus (including amplifiers) that produce heat.
15. Refer all servicing to qualified service personnel. Servicing is required when the apparatus has been damaged in any way, such as power - supply cord or plug is damaged, liquid has been spilled or objects have fallen into the apparatus, the apparatus has been exposed to rain or moisture, does not operate normally, or has been dropped.
16. Mains plug is used as disconnect device and it should remain readily operable during intended use. In order to disconnect the apparatus from the mains completely, the mains plug should be disconnected from the mains socket outlet completely.
17. Battery shall not be exposed to excessive heat such as sunshine, fire or the like.



WARNING

To reduce the risk of fire or electric shock, do not expose this apparatus to rain or moisture.

CAUTION

Use of controls or adjustments or performance of procedures other than those specified may result in hazardous radiation exposure.

CAUTION: These servicing instructions are for use by qualified service personnel only. To reduce the risk of electric shock do not perform any servicing other than that contained in the operating instructions unless you are qualified to do so.

CAUTION

Danger of explosion if battery is incorrectly replaced. Replace only with the same or equivalent type.

Précaution : Danger d'explosion si les piles sont remplacées de façon incorrect. Remplacer les piles seulement par le même type de pile ou l'équivalent.

FCC Warning Statement

Changes or modifications not expressly approved by the party responsible for compliance could void the user's authority to operate the equipment.

This equipment has been tested and found to comply with the limits for a Class B digital device, pursuant to Part 15 of the FCC Rules.

These limits are designed to provide reasonable protection against harmful interference in a residential installation. This equipment generates, uses, and can radiate radio frequency energy and, if not installed and used in accordance with the instructions, may cause harmful interference to radio communications.

However, there is no guarantee that interference will not occur in a particular installation. If this equipment does cause harmful interference to radio or television reception, which can be determined by turning the equipment off and on, the user is encouraged to try to correct the interference by one or more of the following measures:

- Reorient or relocate the receiving antenna.
- Increase the separation between the equipment and receiver.
- Connect the equipment into an outlet on a circuit different from that to which the receiver is connected.
- Consult the dealer or an experienced radio/TV technician for help.

FCC Radiation Exposure Statement:

This equipment complies with FCC radiation exposure limits set forth for an uncontrolled environment. In order to avoid the possibility of exceeding the FCC radio frequency exposure limits, Human proximity to the antenna shall not be less than 20cm (8 inches) during normal operation.

UNPACKING

Check that you have all of the following items.

If any item is missing, please contact the customer service hotline for assistance.

The hotline number is printed on the cover page of this user manual.

- BTW249 Speakers (x2)
- AC Power Cable (x2)
- Audio Cable
- User Manual (with Warranty Statement)
- Quick Start Guide
- Instructions for Installing Speakers
- Template for Wall Mount
- Metal Screw (x4)
- Plastic Sleeve (x4)
- Anchor (x4)

PART DESCRIPTIONS

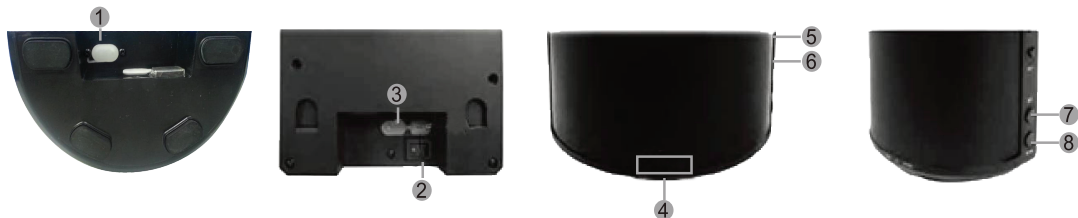

- | | |
|-------------------------|------------------|
| ① Power In | ⑤ Volume+ |
| ② Power Switch | ⑥ Volume- |
| ③ AUX Input | ⑦ BT Button |
| ④ LEDs Status Indicator | ⑧ EZ:PLAY Button |

GETTING STARTED

Power Connection

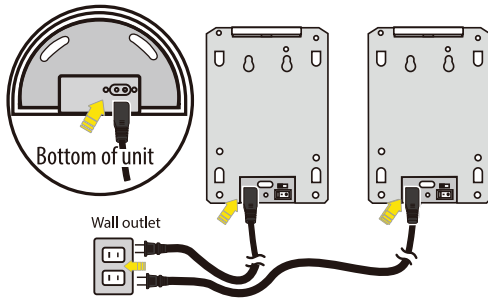

- Connect the supplied AC cable to the speakers
- Plug the AC cord into wall outlets.

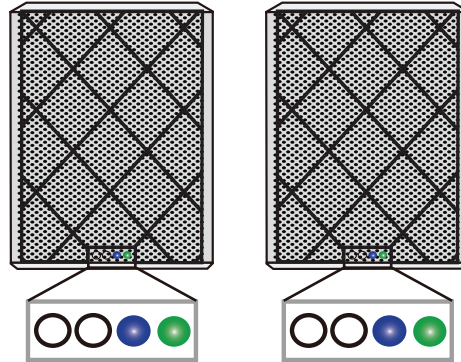

Power On/Off Switch

- Power on the mechanical **Power Switch**.
- The **Power Green LED** will turn On. you will hear Voice confirmation "Power on".
- The unit will enter into Bluetooth mode, the **BT Blue LED** will flash.
- If the 3.5mm Stereo Audio cable is plugged in during this Power On mode, it will automatically enter into Aux mode.
- If the unit is left no action for more than 10 minutes, the unit will enter to Standby mode automatically. All LEDs turn Off.
- Press "**BT**" or "**EZ-Play**" button to wake up the unit.
- Note: The unit will not go into Standby in Aux mode.

Charging Battery

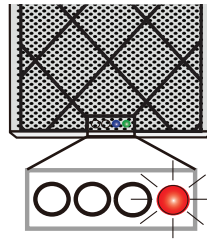

- By connecting AC power, batteries will be charged and **Red LED** will turn on.
- **Red LED** indicator will turn off when unit is fully charged.
- If **Red LED** indicator is flashing, this means that battery levels are low and need charging.
- Charge batteries about 10 hours before you start using the units for the first time.

BLUETOOTH CONNECTION (Bluetooth Devices and Speakers)

Bluetooth connection (pairing) between your Bluetooth device and the Speakers can be completed by using NFC or manually. Your Bluetooth device must be NFC enabled to complete pairing automatically by using NFC.

Bluetooth pairing by using NFC

- Turn on Bluetooth function on you Bluetooth device.
- Place your Bluetooth device on the silkscreen "NFC" on the top surface of one unit.
- Paring will be completed automatically, and Bluetooth Blue LED indicator on
- Once paired, you can play audio from your Bluetooth device and audio can be heard from this unit.

Note: If pairing won't be complete automatically, please use the manual pairing since your Bluetooth device may not be NFC enabled.

Manual Bluetooth pairing

- Place one Speaker and your Bluetooth device so they are no more than 3 feet apart,
- Press and hold "BT" button on Speaker for 2 seconds to enter into Bluetooth pairing mode. BT Blue LED will flash rapidly.
- Make sure Bluetooth function of your Bluetooth device is ON.

<Continued to next page>

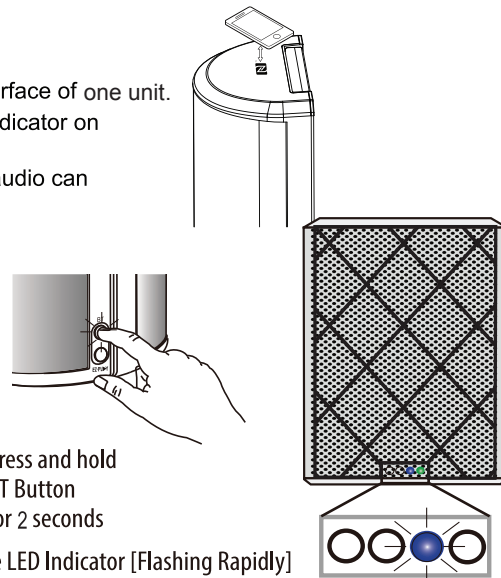

Press and hold
BT Button
for 2 seconds

Blue LED Indicator [Flashing Rapidly]

Manual Bluetooth pairing-continued

- Set your Bluetooth device to search for Bluetooth devices. You will recognize the unit by its Bluetooth name MONSTER BTW249
- Once selected, your Bluetooth device will indicate "Connected", and you will hear the words "Pairing Completed"
- BT Blue LED turns on upon completion of pairing.

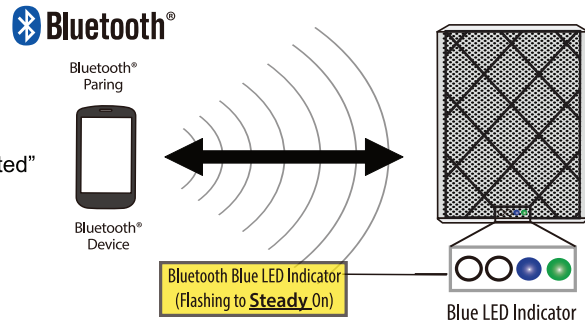

EZ-Play WIRELESS CONNECTION (Between Speakers)

- Press and hold the **EZ-PLAY** button on the first unit for 2 seconds to send connection request to **EZ-PLAY** unit
- **EZ-PLAY Amber LED** on Rx unit will flash.
- Press and hold the button on the second for 2 seconds to scan connection request from Rx unit.
- **EZ-PLAY Amber LED** on Tx unit will flash during scanning.
- **EZ-PLAY Amber LED** on both units will turn steady on upon completion of connection.
- Once complete, the same audio will play on both speakers.

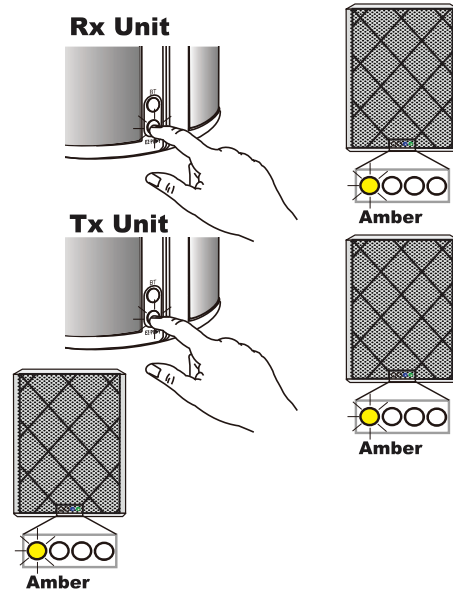

Wireless Speaker Auto Connection

Once the above wireless connection is completed, the Tx unit and the Rx unit will be connected automatically whenever they are turned on together.

CONNECT TO MULTIPLE SETS OF BTW249 SPEAKERS

- You can wirelessly connect multiple speakers (up to 8 units) by purchasing extra sets of BTW249
- Tx units of the extra BTW249 sets need to be converted to Receiver unit so that they can be wirelessly connected to the Tx unit of 1st BTW249 set.

Tx to Rx conversion

- Press **EZ-PLAY** button for 5 seconds converting Tx unit to Rx unit.
- In this case, BT function is turn off, and **BT Blue LED** will turn off.
- Tx unit is now converted to the Receiver unit and will function like the Rx unit.
- Aux In will not function after above conversion.

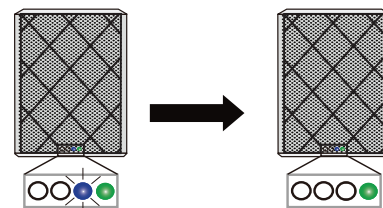
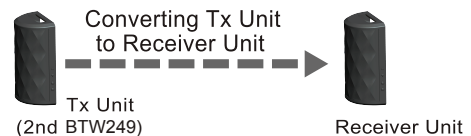

To connect 3rd~7th additional speaker units

- Repeat the same steps described in "**EZ-PLAY Wireless Connection (Tx Unit And Rx Unit)**" above.

CONNECTION USING AUX INPUT

- Plug in the 3.5mm Stereo Audio wire into the Aux-In input, and the unit will enter into Aux mode and the **BT Blue LED** Indicator will turn off.
- You can connect any audio device that has 3.5mm audio output jack, and can playback any audio from this connected device.
- All playback functions (Play, Pause, Next, Previous, Volume Up & Volume Down) can be controlled from the connected Audio device.

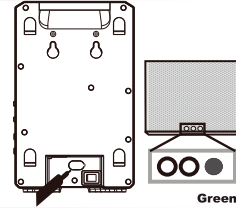

LED STATUS INDICATORS

Power Switch : On

Power Green LED	On Off	Unit power on mode Unit in Standby mode
Charging Red LED	Off Low Flash On	Unit in Standby mode/ Fully charged Low Battery indication Charging in progress
BT Blue LED	Steady On Low Flash Fast Flash	Unit is connected with BT device Unit is in BT waiting mode Unit is in BT pairing mode
EZ-PLAY Amber LED	Steady On Low Flash Fast Flash	EZ-PLAY Wireless devices connected No connection/ Lost connection Scan (Tx) / send (Rx) connection request

Power Switch : Off

Power Green LED	Off	Unit in Power Off condition
Red LED	Off On	Fully Charged Charging in progress
BT Blue LED	Off	Unit in Power Off condition
EZ-PLAY Amber LED	Off	Unit in Power Off condition

AUDIO CONFIRMATION

Audio (Voice) Confirmation	Situation
Power on	The power is turned on.
Pairing	Bluetooth pairing is in process.
Pairing completed(with Beep)	Bluetooth pairing was completed successfully.
Pairing not completed	Bluetooth pairing has failed.
Disconnected	Bluetooth disconnected manually via BT device.

WALL MOUNTING

Use the supplied template with the following instructions.

1. Mark for 2 holes A and B on the wall where you want to mount the speaker by using the supplied template.
2. Make 2 holes on the points where you marked on the wall by using a #8 (0.199", 5 mm) drill bit.
3. Insert the supplied anchors (Fig. 1) completely into the holes.
4. Make the screw sets that are shown in Fig. 2 by inserting the supplied metal screws into the supplied plastic sleeves, and install them to the anchors. Make sure that the plastic sleeves are firmly secured.
5. Hang the speaker on the screw sets by inserting the heads of the screws into the teardrop openings provided on the rear of the speaker. After inserting them, make sure to slide the speaker down by about 0.4" (11 mm) so that the top edges of both teardrop openings securely sit on the plastic sleeves.

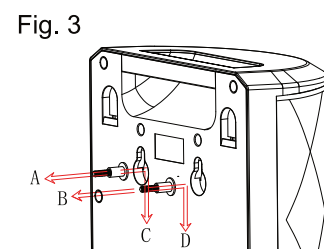
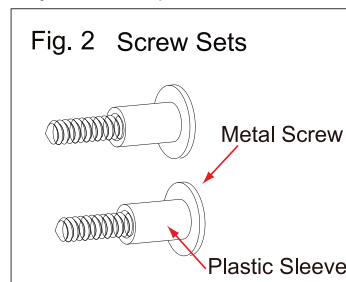
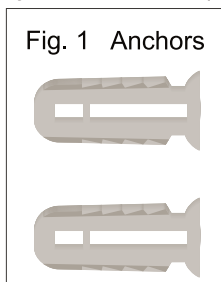

TROUBLESHOOTING

General

No power

- Check the AC power cord is securely inserted in the unit and the electrical outlet.
- Check the Power On/Off switch is turn to On position.
- If battery is flat, Plug in the AC power cord to charge and operate.

Keys no response

- Turn the Power On/Off switch to Off, and then On again to reset the unit.
- Unplug the AC power cord and plug is back again.

No sound heard

- Make sure the Aux connected device volume is turn to reasonable level.
- Make sure the Bluetooth connected device output the audio thru BT out.
- Make sure the Bluetooth connected device volume is turn to reasonable level.

Bluetooth Operations

Audio quality is poor

- Bluetooth reception is poor. Move the Bluetooth device nearer to the Tx unit.

Cannot pair to Bluetooth device

- Make sure both Bluetooth device and Tx unit is not connected to any other Bluetooth device.
- Make sure the Bluetooth On/Off switch located below Tx unit is slide to On position.
- Make sure the Blue LED on the Tx unit is fast flashing (Pairing mode).
- Turn Power switch to Off, and then On again. Press and hold BT button for 2 seconds to enter into pairing mode.

EZ-Play Wireless Link Operations

Audio quality is poor

- EZ-Play wireless reception is poor. Move the Receiver unit (Rx) nearer to the Tx unit

Cannot connect the Receiver unit (Rx) to Tx

- Move the Rx unit near to the Tx during connection request.
- Turn Power switch to Off, and then On again. Press and hold **EZ-PLAY** button for 2 seconds for sending wireless connection request.

SPECIFICATIONS

Amplifier

RMS output power :	10W per ch, 10% THD
Total RMS power (Tx & Rx) :	40W
Frequency response :	20 Hz - 20 kHz

Aux In

Aux Input :	Stereo, 3.5mm Jack
Mode switch :	Auto

Speaker

Type :	Full range, 3.0", 4Ω, water resistant
--------	---------------------------------------

Bluetooth

Bluetooth specification :	Ver. 3.0 +EDR
Wireless output power :	Class 2 (2 dBm)
Support profiles :	A2DP
Working range :	10M (line of sight)

EZ-PLAY

Wireless type :	EZ-PLAY Bi-Directional
Wireless output power :	Class 2 (12dBm)
Maximum connected unit :	8 Stereo units
Working range :	30M (line of sight)

Built In Battery

Battery type :	Li-ion, 11.1V
Battery life :	5 hours

General

Power Supply :	AC 100V-240V/50-60Hz
Power consumption :	30W
Standby power consumption :	1W
Dimension (WxHxD) :	6.5" x 10.2" x 3.9", 165mm x 260mm x 100mm
Mass (Net Weight) :	8.2lbs., 3.7 kg

Limited Warranty

Model BTW249

This Monster-branded product, marketed as new, in the original carton to the original purchaser ("Product"), is warranted by Russell Distribution Company, LLC against manufacturing defects in materials and workmanship for a limited warranty period of Ninety (90) Days for Labor and One (1) year for Parts. This Limited Warranty is conditioned upon proper use of Product by you, the Purchaser.

This Limited Warranty does not apply to store display products and product sold as a "marked down" special, in "as is" condition, "close outs", "liquidation and clearance sales", "open box", products missing accessories, or no fault found.

Proof of purchase in the form of a Bill of Sale, Receipt or Receipted Invoice is evidence the Product is within the limited warranty period. The Bill of Sale, Receipt or Receipted Invoice must be presented as a pre-condition to obtaining the limited warranty service.

This limited warranty begins on the original date of purchase and is valid only on Products purchased through authorized dealers and used in the United States, and Puerto Rico, by the original Purchaser. To receive warranty service, the Purchaser must first contact us for problem determination and service procedures. The original dated bill of sale, receipt or receipted invoice must be presented upon request as proof of purchase.

We will repair your product or if repairs cannot be made, we will replace it at no charge with the same or similar product. If the Product is defective as specified in this limited warranty during the limited warranty period, we may use new or remanufactured parts to repair the Product. All replaced parts and products become our property and must be returned to us. Replacement parts and products assume the remaining original limited warranty, or ninety (90) days, whichever is longer.

Product freight must be prepaid by you, the original Purchaser and shipped in either its original packaging or packaging affording an equal degree of protection. We will not be responsible for or obligated to replace damaged Products.

If the Product is received damaged, it is your responsibility as the consumer to file a claim against the carrier. We will only store the damaged Product for 30 days and reserve the right, in our sole discretion, to dispose of the damaged Product or ship it back to you at your expense after 30 days.

This limited warranty covers manufacturing defects in materials and workmanship encountered in normal, and except to the extent otherwise expressly provided for in this statement, noncommercial use of this Product, and shall not apply to the following, including, but not limited to: Damage which occurs in shipment; delivery and installation; applications and uses for which this Product was not intended; altered Product or serial numbers; cosmetic damage or exterior finish; accidents, abuse, neglect, fire, water, lightning or other acts of nature; use of products, equipment, systems, utilities, services, hardware, supplies, accessories, applications, installations, repairs, external wiring or connectors not supplied or authorized by us or the manufacturer, which damage this Product or result in service problems; incorrect electrical line voltage, fluctuations and surges; customer adjustments and failure to follow operating instructions, cleaning, maintenance and environmental instructions that are covered and prescribed in the instruction book; reception problems and distortion related to noise, echo, interference or other signal transmission and delivery problems; burned-in images. Uninterrupted or error-free operation of the Product is not warranted.

THERE ARE NO EXPRESS OR IMPLIED WARRANTIES OTHER THAN THOSE LISTED AND DESCRIBED ABOVE, AND NO WARRANTIES WHETHER EXPRESS OR IMPLIED, INCLUDING, BUT NOT LIMITED TO, ANY IMPLIED WARRANTIES OF MERCHANTABILITY OR FITNESS FOR A PARTICULAR PURPOSE, SHALL APPLY AFTER THE EXPRESS WARRANTY PERIODS STATED ABOVE, AND NO OTHER EXPRESS WARRANTY OR GUARANTY GIVEN BY ANY PERSON, FIRM OR CORPORATION WITH RESPECT TO THIS PRODUCT SHALL BE BINDING ON US. REPAIR OR REPLACEMENT AS PROVIDED UNDER THIS LIMITED WARRANTY IS YOUR EXCLUSIVE REMEDY AS THE CONSUMER. WE SHALL NOT BE LIABLE FOR ANY INCIDENTAL, OR CONSEQUENTIAL DAMAGES FOR BREACH OF ANY EXPRESS OR IMPLIED WARRANTY ON THIS PRODUCT; EXCEPT TO THE EXTENT PROHIBITED BY APPLICABLE LAW, ANY IMPLIED WARRANTY OF MERCHANTABILITY OR FITNESS FOR A PARTICULAR PURPOSE ON THIS PRODUCT IS LIMITED FOR THE DURATION OF THIS LIMITED WARRANTY. THIS LIMITED WARRANTY SHALL NOT EXTEND TO ANYONE OTHER THAN THE ORIGINAL PURCHASER OF THIS PRODUCT, IS NONTRANSFERABLE AND STATES YOUR EXCLUSIVE REMEDY.

Some states do not allow limitations on how long an implied warranty lasts, or the exclusion or limitation of incidental or consequential damages, so the above limitations or exclusions may not apply to you. This limited warranty gives you specific legal rights, and you may also have other rights which vary from state to state. Any provision contained herein which is found contrary to state or local laws shall be deemed null and void and the remaining provisions shall continue in full force and effect.

To obtain warranty service:

Telephone: 800-976-0677

Ver. 130828-1



Monster and the M Monster logo are registered trademarks of Monster, Inc. and its subsidiaries in the U.S. and other countries, used under license. Pure Monster Sound is a trademark of Monster, Inc. and its subsidiaries in the U.S. and other countries, used with permission.

The Bluetooth® word mark and logos are registered trademarks owned by Bluetooth SIG, Inc. Other trademarks and trade names are those of their respective owners.

Printed in China

Version: 1.0